

2020-21 ANNUAL REPORT

Rossland Museum
& Discovery Centre

Metals | Mountains | Memories

www.RosslandMuseum.ca

Message from the Rossland Historical Museum & Archives Association President

This year has been another busy year despite the restrictions imposed due to the pandemic as well as our desire to be extra cautious whenever possible. We adapted to meetings via Zoom, hybrid meetings, limited sizes for gatherings, etc. *Some of us may have adapted better than others!*

Staff and volunteers continued to work through the goals outlined in our Strategic Plan. As this is the last year of that Plan, it will be reviewed in a planning session in the next year. The archives and artefact collections continued to be organized and research is ongoing. Exhibits continued to be upgraded and new ones designed both in the museum complex and in outlying locations. More online resources and articles continued to be posted on the museum website, and the speaker series continued both online and in-person. Youth programs continued throughout the year and our summer camps continue to be very popular. More details of museum activities can be found throughout the full Annual Report.

We continue to seek funding for Phase 2 of the Renewal Project, a combination of the Mine Experience and Atrium expansion. Planning continues with the architectural firm hired last year: MAD Studio of Penticton. Design work for the exhibit areas completed by Double Dare Design of Vancouver is on hold, waiting for funding for the building in order to implement the plan. The financial situation will hopefully allow us to break ground next summer.

As always, the museum operates on a limited budget but improved visitation with some relaxation of COVID PHO and continued Government COVID relief funding has helped to provide us with a healthy bank balance. Joelle, our Museum Director, continues to do a stellar job in securing grants. She also administers the entire operation, ably assisted by our full and part-time staff and a number of youth positions. I have been asked several times about that number, what do they all do, but I can assure you that they are all kept extremely busy - as you'll undoubtedly notice throughout the report.

The RHMAA appreciates the ongoing support and services supplied by the City of Rossland. This support enables us in large part to continue to operate year after year. We also greatly appreciate the support received from Teck Trail Operations, both annually and with the Renewal Project. Many, many thanks go to our volunteers, members of the Board, the membership, community members and groups, Rossland Rotary, and many others. These volunteer hours are what make much of what we have accomplished possible.

While I am officially stepping out of the limelight that is the President role this year, I can't wait to continue as a dedicated volunteer and see all of our hard work come to fruition over the next few years.

Thank you, everyone!

Libby Martin
President, RHMAA



Table of Contents

Table of Contents	3
About the Rossland Museum & Discovery Centre	4
Season Highlights	6
Covid-19 Impacts	6
Memberships	6
Visitor Numbers	7
Marketing & Communications	8
Programming & Special Events	9
School Tours	9
Online Resources	9
Kids Programs	9
Adult/Senior Programs	10
Additional Programming for Everyone	11
Annual Community/Holiday Events	12
Collection, Archives, & Research	14
Museum Updates	14
Travelling Exhibition	14
Satellite/Temporary Displays	14
Archives & Collection Workshops	14
Archives & Collections Updates	14
Digital Museums Canada Community Stories Virtual Exhibit	16
Permanent Collections	16
Funding and Earned Revenue	18
2022 Goals & Special Projects	19
Renewal Project Update	20

About the Rossland Museum & Discovery Centre

The Rossland Historical Museum & Archives Association was established by the Rossland Rotary Club in the basement of the Rossland Court House in 1954 and was incorporated under the BC Societies Act in March of 1955. The present museum was built on the site of the historic Black Bear mine in 1967 as a Canadian Centennial project with the leadership of Jack McDonald, Roger Terhune, and numerous other dedicated community members. More than five decades later, we are on 5 acres of property with 11 buildings and 8 open-air exhibition shelters covering topics such as mining and skiing as well as the industrial, social, cultural, and natural history of Rossland. In 2015, we rebranded the organization the “Rossland Museum & Discovery Centre” - and developed a tagline to encompass our history in three short and sweet words - *Metals / Mountains / Memories*.

Mandate:

The Rossland Museum & Discovery Centre includes:

- a) The collection, preservation, and presentation of objects, specimens, and documentary heritage to illustrate and make known to the public the mining, industry, skiing, social, cultural, and natural history of Rossland and area; and
- b) The promotion of education, research, and programming in any or all fields referred to above.

Mission:

To preserve and dynamically present the history and heritage of Rossland and area and to inspire and engage the public through virtual and real-life presentations that bring our history and heritage to life.

Vision:

- To be the visitor gateway to the Kootenays and the Columbia Basin
- To be a landmark site to congregate, create, and strengthen links between diverse communities in the region
- To be an active presence in the community that supports the local economy, spurs partnerships, and regenerates tourism

Rossland Museum & Discovery Centre

2018 - 2021 Strategic Goals



Human Resources

- **1 Permanent Employee**
Museum Director - *Joelle Hodgins*
- **4 Contract Department Managers**
Research Manager - *Sarah Taekema-Slot*; Collections Manager - *Sara Wright*; Operations & Marketing Manager - *Fiona Lane*; Community Engagement Manager (to July 2021) - *Emily Roberts*

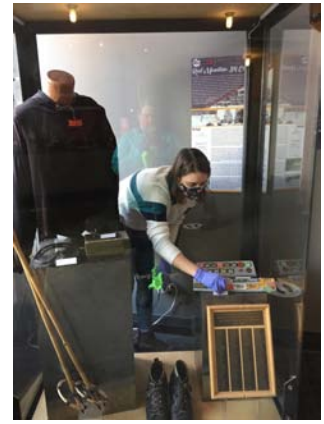

Columbia Basin Trust, Young Canada Works, and Canada Summer Jobs programs enabled us to create **20 youth opportunities**: 7 youth in the winter and 13 in the summer with 6 of those summer employees being able to continue their job terms through the fall and next fiscal year - **this was possible with just over \$102,000 in funding** covering 78% of the total cost of these positions. Comparatively, we had 7 students in 2020 with \$57,000 in funding, covering 80% of the cost.

78%
student wages
funded

Our youth work opportunities program is essential and provides reciprocal benefits for the museum and our youth - they gain useful career skills while helping us in so many ways, such as operating our Camp Black Bear Summer Camps, working on collection, archives, and exhibit projects, offering tours as historical interpreters, and assisting with daily museum and visitor centre operations.



Volunteers

2020 Board of Trustees:

- Libby Martin - President
- Deke Baley - Vice-President
- Gabe Wiebe - Treasurer
- Carol Cooper - Secretary
- Maureen Brown - Trustee
- Mike Sloan - Trustee
- Troy Colautti - Trustee



Standing Committees: Human Resources, Policy, Finance, Fundraising & Volunteers, and Collections & Research

Regular Volunteers - 90 people

Renewal Plan Development Committee - 12 people (Mayor, City CAO, City Council Liaison, Teck Community Engagement Liaison, Museum Consultant, Committee Facilitator, Tourism Rossland Executive Director, 3 Board Trustees, Museum Director, and Community Members)

Rotary Club of Rossland regularly helps with property upkeep and event support including a minimum of two major work bees annually to handle seasonal changeovers for the property as well as additional landscaping and project support, including carpentry, display installations, event support, and more.

Seven Summits Centre for Learning often coordinates student volunteers to help out with certain things at the museum including special events, decorating, and helping with cleaning throughout 2020-21. These students often work with us in future student job opportunities, so it's a great starting point!

Recorded Volunteer Hours - 2126 valued at \$15/hr = \$31,890 in volunteer contributions (1117 hours/\$16,755 in 2019-20) In addition to the recorded hours, the Board of Trustees and other committee members put in countless hours outside of the museum in planning and research.

We have a number of incredible event/programming support volunteers that do everything from decorating to baking to operating booths at special events on our behalf. We also have a very dedicated crew of volunteers that take care of our beautiful Heritage Garden on the upper bench!

We can't thank everyone enough for this generous and continued show of support.

Season Highlights

Covid-19 Impacts

We have been managing the public health orders as they come with our [COVID-19 safety plan](#) to ensure the safety of our staff, volunteers, and visitors. Masks have been required to enter the museum all year, and we really appreciate the public's support in this effort.

While we were able to safely host many programs and events during the summer, the need to gather indoors during the winter has made it difficult to continue our school year programs. We are really looking forward to restarting things as soon as it is safe to do so.



Memberships

167 Members and \$2993 revenue (2019-20 = 273 members and \$2997)

Benefits of an Annual Membership:

- Season's Pass to the Museum + 2 family/friend guest passes
- E-Newsletter subscription
- 10% off program fees, in the museum shop, and with facility rentals/birthdays
- Annual General Meeting vote
- Reciprocal Membership Programs:
 - [Association of Science-Technology Centers Travel Passport](#)
 - [Canadian Association of Science Centres](#) program
 - [Gallery 2](#) program

In addition to these membership programs, members of the BC Museums Association can access the museum at no cost under the Owl Pass Program.

We are also members of the [CANOO Pass](#) from the Institute for Canadian Citizenship, which helps new Canadian citizens celebrate their citizenship by providing free virtual and in-person admission to over 1400 museums, science centres, art galleries, parks, and historic sites across Canada



We also have a partnership with the Rossland Public Library to provide a family pass that can be checked out anytime by local families to visit the museum for a week!

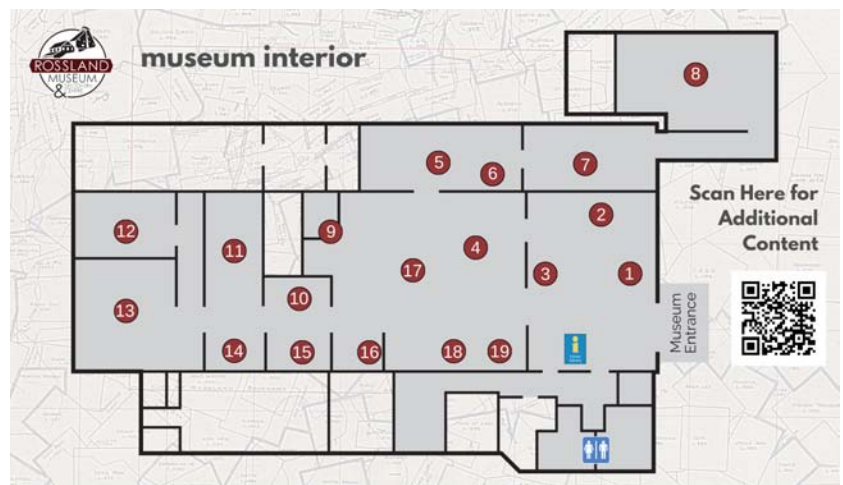

- | | | | |
|-------------------------------------|------------------------------------|---------------------|-------------------------------------|
| 1. Museum Shop | 6. Cabinet of Curiosity | 12. Cominco Theatre | 17. Father Pat's Memorial Ambulance |
| 2. Early Mining | 7. Bottle Room | 13. Cominco Wing | 18. Sinixt History |
| 3. Natural History | 8. Ski History Wing | 14. Kitchen | 19. Geological History |
| 4. J.D. McDonald History Hall | 9. Rossland Vices | 15. Parlour | |
| 5. West Kootenay Power & Light Wing | 10. Post Office | 16. Winter Cabin | |
| | 11. Hunter Brothers' General Store | | |

Visitor Numbers

2020-21 Season Total = 6951

2% increase from 2019-20 season (6811 visitors)

91% or 6,353 visitors were there for the Museum & Archives (as opposed to Visitor Centre-only visits)

Locals = 77.8% (2020: 72.8% of visitors)

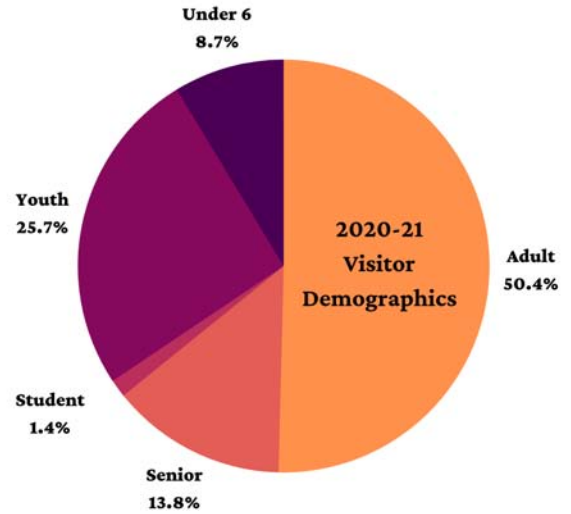
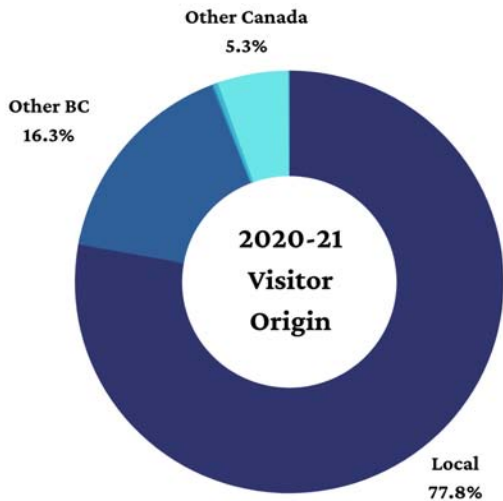

The Museum Visitor breakdown is:

Adult:	50.7%	(2020 = 48.2%)
Senior (60+):	14.5%	(19.3%)
Student:	1.5%	(1.2%)
Youth (under 18):	24.7%	(23.4%)
Under 6:	8.6%	(7.8%)

Visitor Numbers

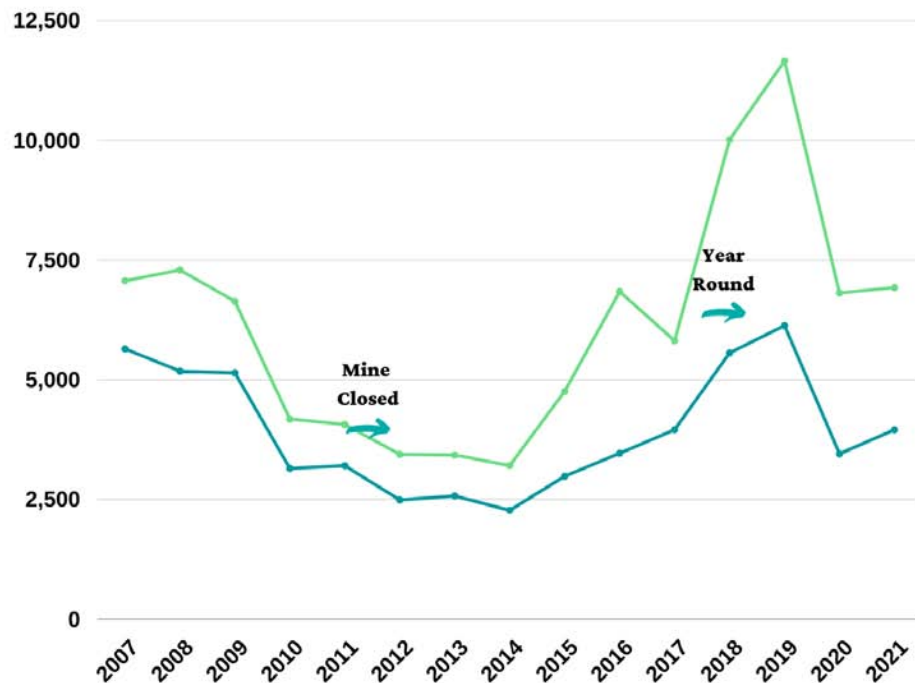

Marketing & Communications

As we know, it doesn't matter if you're doing great things if no one knows about them! We are working on increasing our visibility in the community, including a greater effort to share our content online for a wider audience - especially during the COVID-19 pandemic.

Our current marketing budget is relatively low and often tied up in redeveloping old signage or promotional pieces. Therefore, we largely focus on our "free" marketing opportunities including:

- **Facebook Page** - facebook.com/rosslandmuseum - Likes: 1645 (2020: 1503); Reach: 73,477 (2020: 70,172)
- **Twitter Page** - @RosslandMuseum - Followers: 763 (2020: 722)
- **Instagram Page** - @RosslandMuseum - Followers: 1452 (2020: 1212); Reach: 14,980 (2020: 19,244)
- **Visitor Centre Social:** In July 2020, we created new accounts for the Visitor Centre as an added communication channel for tourists that don't consider the museum accounts to ask general visitor questions. In addition, the accounts allow us to share and promote existing community content, which has also helped us stay in the loop in order to share info with our visitors.
 - **Instagram** - @ExploreRosslandBC - followers: 580 (2020: 197)
 - **Twitter** - @ExploreRossland - followers: 28 (2020: 17)
- **Trip Advisor:** #3 of 13 things to do in Rossland - 31 Reviews - 4.5/5 stars
- **Google Business Listing:** 78 Reviews - 4.5/5 stars
- **Bubble** - website fed by event calendar
- **Local Media**
 - Current Program with **Rossland News:** In-kind weekly advertisements in exchange for contributing an interesting historical photo to go in the paper – Value: \$25/week - \$1300/year in-kind
 - Maureen Brown has also been submitting regular updates to the local papers
- **E-Newsletter:** 579 Subscribers (2020: 463)
- **Website:** 21,070 unique visitors (2020: 14,348); 47,182 page views (2020: 26,231)

Other:

- Kootenay Gateway and Rossland Fine Wines (as well as the Library & Ferraros on occasion) have allowed us to put out a sandwich board with upcoming events every day
- City of Rossland:
 - Mayor & Council include upcoming events/project updates in the bi-monthly council newsletter
 - We occasionally book the City Events sign at the corner of Columbia and St. Paul for upcoming events
- Destination BC/Hello BC – online and in print

In the News: Summer sizzles in Rossland - *SOAR Magazine*: www.trailtimes.ca/travel/summer-sizzles-in-rossland/

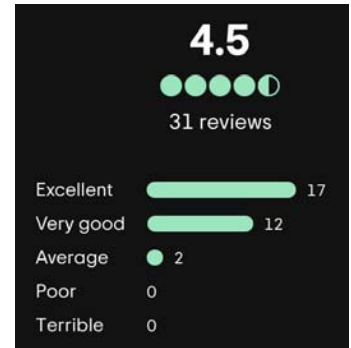

Reviewed by **Adrian**
30 Aug 2021

Lots to explore
★★★★★

A relatively expansive museum compared to several museums I visited in the Kootenay. It is right at the junction of two highways. I checked out the outdoor displays first. Climbed into an old Canadian Pacific train cabin and an old fire truck. There is a room only displaying precious stones and gems from local and far away. Upon entering the indoor museum, there is the admission office, washroom and a gift shop. Glad to see the first display is about the lives of Chinese workers in the region from the early 1900s. Lots to explore for the rest of the museum. Learned about Nancy Greene, a Rossland resident since the age of two and a Winter Olympic medalist (Gold & Silver) in the 60's.

E **ExploreRosslandBC**
★★★★★ 20 weeks ago
What a fantastic museum. Much much more than we had expected. Learned a lot and enjoyed ourselves. We highly recommend visiting.

ATTENTION SENIORS!

Join us during any of the Senior Tuesdays in March for a personal demonstration on our new Community Portal - online collections database!

Tuesdays 10am-12pm
Entry by donation

More info: www.rosslandmuseum.ca

Programming & Special Events

Educational Tours:

- General Rossland History - Grades: All
- Diggin' it Geology Tour - Grades: K - 12
- Chinese History Tour - Grades 5 - 12
- Animal Homes, Human Homes - Grades: Pre-K - Grade 5
- Exploration of First People's History - Grades: 4 - 12
- Additional topics and specialty tours based on events/temporary exhibits on display



School Tours

Many classes/schools were still unable to book off-site tours this year, and we were unable to host Pro D day and early dismissal day programs. We look forward to organizing these again in the future! Nonetheless, we hosted **174 participants from 7 classes** (2019-20 = 138 participants from 6 classes)

Educational Discovery Kits:

420 users from 14 rentals and 9 on-site uses

Rossland Museum Discovery Kits:

- Indigenous Basketry of the Region
- Rock Detectives
- Ecology Discovery (see image >)
- Drawn to History
- Remembrance Day Kit



We are also the home base in Southeastern BC for other museums, organizations, and schools to borrow various kits from the Royal BC Museum:

- Writing on the Wall: An Outreach Kit on Chinese Canadian Historical Wrongs
- "Species at Risk" Mini Museums (Western Bumble Bee, Hotwater Physa, and Spadefoot Toad)
- 2020-22: "Having a Voice: Voting Rights & Democracy in BC"

Online Resources

Throughout the pandemic, we have developed and maintained a collection of online resources for people to "Museum From Home" or to utilize in their at-home learning OR just enjoy the material at their leisure!

We created [lists of resources](#) as well as developed our own content for four categories: *Seniors*, *Youth*, *Toddlers*, and *Everyone*. This included digital puzzles, museum alphabet, Rossland Memories collections, and more as well as a collection of great resources from other museums and educational sites. We got a lot of great feedback on this, and we hope to continue it post-pandemic.

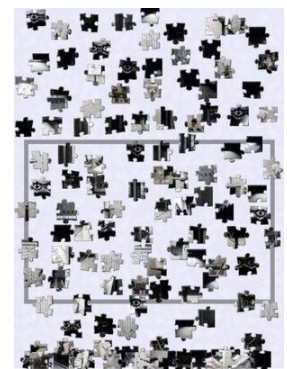

Kids Programs

- **Rockhounds:** Weekly, 2-hour program during the school year connecting kids ages 6-12 to geology - a big thank you to Fergus Tweedale and other members of our Geology Club for supporting the program development this year.
- **Young Naturalists:** Weekly, 2-hour program during the school year for ages 8-14 to dig a bit deeper into ecological topics
- **Cub Club:** Weekly preschool science exploration program during the school year with varying themes; this was our most popular program by far this year, and while it is on hold right now, we can't wait to get started again in the new year.

- **Homeschool Morning:** Monthly program for homeschool kids centred on history, art, and science with connections to the BC curriculum. Different themes are explored each month that touch on exhibits in the museum; we also occasionally host homeschool groups from around the region to tackle specific curriculum-based topics.
- **S.T.E.A.M. Days:** Saturday craft/experiment program that creates thematic crafts and art throughout the school year with a focus on science, technology, engineering, art, and mathematics (S.T.E.A.M.) - this was reconfigured to allow for take-home kits for much of Winter 2020, which was a big hit.
- **Spring Break Camps** - we were very excited to hold these camps again despite a limited capacity. With 10 kids per week, we went on a Quest to Camelot in the first week and became Masters of the Renaissance in week 2! We had 4 community organizations and 3 volunteers help us make it happen.
- **Camp Black Bear:** We held nine full weeks of camps with five different topics: Fantasy Camp, Adventure West, Camp Rock, Junior Shredders, and Stroke of Genius Art Camp
 - Average of **15 kids daily - a total of 670 campers** (2020 = 562)
 - Volunteer assistance from Hollie Waterfield, Backcountry Horseman's Association and Richie Mann, Wildsafe BC, Cindy Devine, Ron Dennet, Rory Belter, Laurie Broadhurst, VISAC Art Gallery, the City of Rossland's Watersmart Ambassador, Rebecca Schulze, and Chris Hatch
 - Partners/Contractors: Kootenay Mountain Bike Coaching, Flux Climbing, Trail Martial Arts, and Giant Water Bug



Adult/Senior Programs

- **Monthly Speaker Series:** Due to COVID-19, our Speaker Series transitioned to mostly virtual, but we did manage to host a very interesting and diverse Speaker Series this year! Monthly presentations on various topics included: the "Spanish Flu" in Rossland, film + filmmaker talk on Selkirk Mountain Caribou, history of the labour movement as told through the lens of mining town architecture, competitive downhill mountain biking, Sinixt dialect revitalization and counter-mapping, and whitebark pine ecology and restoration.
 - Thank you to Linda Gomez, Bryce Comer, Harry Measure, Sinixt Smum iem Matriarch Marilyn James, Cindy Devine, and Adrian Leslie
 - We would also like to thank the Trail & District Arts Council for supporting this programming, and our local businesses for contributing to these events, including Gabriella's Restaurant and Sourdough Holdings
 - All presentations are available for viewing on our website anytime
- **Night at the Museum Events:** Two evenings of exploration with special activities and guests. July Night at the Museum functioned as a Community Showcase with some local vendors and community groups; August Night at the Museum was a student showcase highlighting some of our summer students' projects, including research about Rossland veterans, contributions to the development of a Downtown Walking Tour, and an exhibit entitled "Small Artifacts, Big Backstories."
- **Senior Teas:** While we have been unable to host our monthly Strawberry Teas due to PHO, we began Senior Tuesdays as a weekly opportunity for seniors to safely visit the museum before sharing their



memories and great stories with us over tea and coffee. We hope to restart this program as soon as it's safe to do so.

- **Community Clubs** - thanks to a social grant from the Columbia Basin trust, we recently created two new community interest clubs to assist with upcoming projects:
 - **Friends of the Roger Terhune Geology Collection** (“Geo Club”) is a support/expert body on geology-related areas of the RMDC (11 members to date)
 - Activities:
 - Began a geology A to Z resource
 - Exploring updating the current geology display and planning for the future display coming with the Phase II Mine Experience project
 - Mapping and planning for geology walking tours for Spring 2022
 - Planning for geology Speaker Series presentation(s)
 - **Ecology Club** (“Eco Club”) is a support/expert body on botany and ecology-related areas of the RMDC, including advising on upper-level redevelopment plans and the development of a new ecology exhibit, speaker series events, and online resources (9 members to date). This was a quiet year for the group, but things will get busier once funds are secured for the upper-level redevelopment project.
 - Activities:
 - Maintenance of the Heritage Garden
 - Subject matter experts and supporters for writing grants to fund the upper-level redevelopment project

Additional Programming for Everyone

- **Ask a Geologist Mornings:**
 - Saturday, July 24th and August 28th, featuring Christopher Hatch, Mineral Engineer, and member of our Geology Club. Over the course of the two mornings, more than 60 people attended, many bringing rocks for Chris to identify. Chris also brought along his amazing fluorescent minerals display for visitors to enjoy.
- **Guided Tours:**
 - Outdoor exhibit tours: Our Historical Interpreters led two tours per day around the upper level again this summer. We also had new resources for kids to take along, including object and colour scavenger hunts. On occasion, we had to make some modifications due to smoke and poor air quality. Total attendees = 190 (2020 = 150)
 - Gold Fever Follies Vignettes: cast members from the Gold Fever Follies performed vignettes following the morning tours on Fridays and Saturdays for the last half of the summer, ultimately visiting six times
- **Self-Guided/Audio Tours:**
 - **Indoor & Outdoor Tour:** We continue to develop content for self-guided indoor and outdoor Museum tours, including accessible tours for people with disabilities. Additional content for these tours can be viewed anytime [on our website](#).
 - Topics completed this year:
 - Mater Misericordiae Hospital
 - Hunter Brother’s General Store
 - Early Women’s History
 - Sinixt Peoples
 - Old Glory Weather Station/Fire Lookout



- **Downtown Audio Tour:** In September, we completed the [audio content for 5 of the downtown historic buildings/sites](#) as part of the Downtown Audio Tour project. We hope to complete this project by Spring 2022 and make the audio tour accessible through QR codes on the heritage plaques installed on each building/site by the City of Rossland Heritage Commission.
 - Webpages developed this year: Montreal Hotel, Stone Block/Bank of Toronto, Burns Block, Bellevue Hotel, Velvet Block, Court House, Lemon Block, Glazan Block, WKPL Office and WKPL Substation Building, Jordan Block, Collins Hotel, Agnew & Co. Building, Rossland Pool, Nancy Greene/Sheep Lake

We regularly organize many special activities attached to local, provincial, and national holidays and events – see below.

Annual Community/Holiday Events

- **October:**
 - Olaus' 164th birthday had to be [celebrated virtually](#) this year, but we interviewed Richie Mann, Roly Worsfold, and Raymond Gaudart to help us make it extra special! Roly and Ray shared stories of Olaus Jeldness, and Richie Mann shared some of his own incredible and fun stories of skiing the hills around Rossland.
 - Halloween “BOO Town” on October 31st with the assistance of RLOP, Trail Safeway, Lisa Henderson, Tanya Lafonde, and R.S.S drama students - 64 guests and 18 volunteers.
 - If you missed it, you can watch a series of the skits on our [youtube channel](#).
- **November:** Veterans Week display and veterans-appreciation community writing campaign - 90 letters sent to Rossland's veterans; hosted our Annual General Meeting and a Public Open House in November
- **December:** Rekindle the Spirit of Christmas kids craft at the Library; late-night holiday shopping nights
- **January:** no community events due to PHO
- **February:** our annual BC Family Day event was unable to proceed as planned due to restrictions, so we opened the museum up by donation all weekend instead with lots of outdoor activities for families to enjoy - 38 visitors over 3 days
- BC Heritage Week - open by donation all week
 - Created an online Heritage Building Scavenger Hunt and a fun [personality quiz](#) to determine which building best represents you
 - Scavenger Hunt prizes were donated by the Flying Steamshovel, Rossland Council for Arts & Culture, & Gold Rush Bookstore
- **March:** Our Annual Easter Egg Hunt activities had to be cancelled due to COVID-19
- **April:** To celebrate Earth Day, the Rossland Sustainability Commission/ Rossland Refactory held a demonstration of their plastic shredder on the front lawn while we organized a themed STEAM day activity; KinSeed seeds were donated for to-go bags - 25 people in attendance
- **May:** no community events held this month
- **June:** St. Jean Baptiste Day (virtual & in-person activities/crafts), National Indigenous People's Day (in person crafts from Canadian Heritage), Multiculturalism Day (in-person community art project and colouring sheets given to community partners: Rossland Public Library, Ferraros, and Bombshack)
- **July:**
 - Our annual Canada Day celebrations were canceled this year due to the ongoing uncovering of unmarked burial sites of children's remains at the sites of former residential schools in BC and across Canada, which prompted a national pause to reflect, learn more about, and support Indigenous communities across the country. Instead, we provided resources to support Indigenous-led local initiatives leading up to and on Canada Day.



- July 3rd kicked off National Historic Site Day celebrations, and we were open by donation with our heritage site scavenger hunt and prizes.
- **August:**
 - The Columbia Basin Culture Tour is an annual weekend event celebrating culture in the Columbia Basin. This year, we hosted artist Erin Shuttleworth and West Kootenay Live Action Role Play.
 - We were open by donation for BC Day and had a number of thematic craft activities set up for visiting children.
- **September:**
 - Golden City Days and the Fall Fair were cancelled due to COVID-19.
 - Curiosity Clothing hosted our outreach window exhibit “Golden City Fashions: The Fraternal Orders” for two weeks.
 - We hosted our second annual Culture Days Outdoor Artisan Market on the museum property. The event, which brought in more than 500 visitors over the course of the weekend, allowed people to support local artists and artisans while remaining outdoors and socially distanced. The RCAC provided live entertainment.
 - September 30th was Orange Shirt Day and the first National Day for Truth and Reconciliation. In the leadup to the 30th, we sold a stock of 50 “official” orange shirts and donated all proceeds (\$300) to the Orange Shirt Society. We remained open by donation on September 30th to provide resources and to be a place of learning. We donated all of the day’s contributions (\$100) to the Indian Residential School Survivors’ Society.

Additional Activities:

- We hosted Rob MacDonald for a moccasin-making workshop in February - 6 attendees



Collection, Archives, & Research

Museum Updates

- Created new George Grey (ski wing), confectionery (Hunter Brothers), and mine rescue (warehouse) exhibits.
- Refreshed the Sinixt, Caboose, Superintendent's office, Ambulance, and Hockey exhibits.
- Added two Community Portal and one Sinixt oral stories tablet stations to the galleries thanks to project grants from the Canadian Heritage Museum Assistance Programs and the Non-Profit Technology Program from Columbia Basin Trust.



Travelling Exhibition

- December to February: hosted the Rossland Streamkeepers model and info table
- February - May 2021 - Our Living Languages: First Peoples Voices in BC (Royal BC Museum)
 - A sincere thank you to Sinixt matriarch Marilyn James for helping us [welcome the exhibit](#) to the space and to the Sinixt homeland

This program has been supported by the community members of the Nelson & District Credit Union and the Columbia Basin Trust Community Initiatives program.



Satellite/Temporary Displays

- Prestige Hotel - Rossland Breweries (October - April)/Rossland Fires (May - October)
- Curiosity Clothing & Gifts - Winter Carnival Masquerades on Ice (Winter Carnival)/Fraternal Society Clothing (Golden City Days)
- Rossland Library - Remembrance Day (November)/Christmas Toy display (December)
- RMDC - Voting (October-November using "Having a Voice" kit)/Remembrance Day (November)/Christmas (December)

Archives & Collection Workshops

We have been unable to host regular workshops for community members (and nearby museums/archives) due to capacity limitations and physical distancing requirements, but we do still do smaller training sessions with our volunteers and staff as well as incorporating special skills training into the Senior Tuesday program.



Archives & Collections Updates

- Accessioned archival donation backlog
- Continued to develop archival fonds
- Began inventorying/processing archival material
- Began Upper-Level collections inventory
- Large-scale Upper-Level storage building reorganization to properly utilize space
- Launched the [Community Portal](#) (online collections database)



Welcome to the Rossland Museum's Community Portal!

Tips for Searching

Keyword Search

The **Keyword Search** button allows you to perform a general search across multiple fields for any catalog records online. Keyword searches use OR as the default connector between words (e.g. a search for Hanley Ranch will return records associated with Hanley OR Ranch). If you want to find records where both keywords are found, type in AND between the two words. To search for a specific phrase, be sure to put the phrase within quotes (e.g. "Rocky Pine Ranch"). You can also use the asterisk (*) as a wildcard (e.g. a search for histor* would come up with records containing history, histories, historical, etc.). Searches are not case sensitive.

- Completed an inventory of the primary collections room
- Continued to develop our collections database
- Accessioned collections donation backlog
- Catalogued the ski collection and began working on artifacts in the collections room

2017 Canadian Conservation Institute Facility Assessment

We have continued to work our way through the CCI facility assessment. Many of the tasks in the evaluation are ongoing, and we will continue to work through them as we secure funding for supplies and reorganization.

Recently Completed: (in addition to above updates list)

- Rehoused accessioned physical collections items into acid-free boxes
- Rehoused the map collection



Tasks Worked On/In Progress:

- Replacing all non-archival boxes with archival boxes institution-wide
- Moving textiles into acid-free storage boxes
- Repacking artifact boxes to store artifacts properly
- [Father Pat's Ambulance](#) campaign for long-term preservation

Completed Research Requests: 52 (2020 = 52)

In-Progress Research Requests: 11 - many are ongoing projects with no end date (2020 = 30)

Research essays completed throughout the year:

- Women's History Month:
 - "The Girl" - [A Memoir by Susie McClung Inghram](#) (1936)
 - [Alice Jesse Weber](#) - "Old Lady Jess"
 - [Phyllis Gregory Turner Ross](#)
 - [The Rebekahs](#)

- Veterans Week:
 - [Pte. Alfred Lindsay](#) - Canadian Infantry 7th Battalion WWI
 - [Edmund "Eddie" Thomas Cox](#) - RCAF Pilot Officer (WWII)

- Linda Gomez' [Spanish Flu Research](#)
- [Gold Fever Follies: A Rossland Tradition for Over 30 Years](#)
- External:

- Bryce Comer: [South Selkirk Caribou herd](#)
- Adrian Leslie: [Whitebark Pine Ecosystem Restoration](#)
- [Cindy Devine](#): "Ticket to Ride" - Cultivation of a Champion
- Harry Measure's [Heritage Building Research](#)
- Marilyn James: [Sinixt Dialect Revitalization, Countermapping, and Resurgence](#)
- Rossland Evening World by Ron Verzuh - audio interview: <https://rabble.ca/podcast/how-a-little-newspaper-started-labour-journalism-in-canada/>

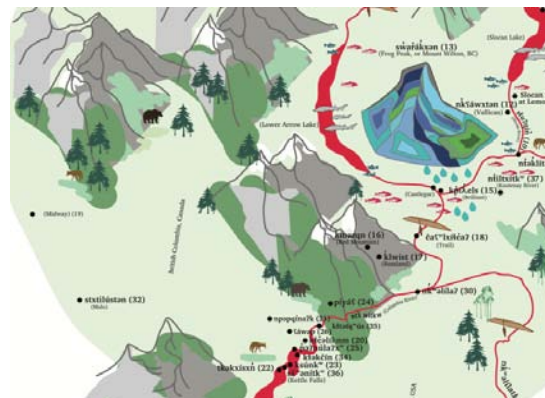

Digital Museums Canada Community Stories Virtual Exhibit

We have begun developing a Community Stories virtual exhibit with Digital Museums Canada on the **History of Ski Racing on Red Mountain, 1898-1989**. We have organized a number of key community members, including past racers and racing volunteers, to help us develop this project. The final online exhibit is expected to be launched in September 2022.

Rossland Memories - Oral History Project

Although it proved very challenging to coordinate oral history interviews for most of this year, we did manage to safely conduct 9 interviews:

Marilyn Houger (nee Turner) | Jackie Drysdale | Libby Martin | Ron Shearer | Jean Gresley-Jones | Dawn Anderson (nee Hird) | Nancy Bowie | Clark White (Part 2) | Terry Lepage/Klister Klub Cabin

In many cases, we did interviews over the phone, which allowed us to continue the project and connect with people who were unable or unwilling to be interviewed in person. Typically we like to film the interviews, but we were unable to do this with any phone interviews.

Ben Walker (audio/video editor) has been editing recent interviews to create publicly accessible files with the support of the CBT Community Initiatives Grant and Digital Museums Canada Community Stories grant. Maureen Brown has volunteered to continue this project so we can catch up with our ever-growing list of great storytellers in our lovely little town's history - thank you Maureen!



Permanent Collections

Archival Collection:

- Textual Records: **approx. 600 linear feet** of textual records
- On Exhibit: **100 documents/photos/maps** (27 on loan)
- Maps/large archival documents: **1,100+** documents/maps (flattened over 850 - digitized 500+)
- Photographs: **approximately 10,000** photographs in the permanent collection. Our continued partnership with the Columbia Basin Institute of Regional History has allowed for **8,722** of our photographs to be digitized at no cost to us. About **19%** of the collection is now [accessible online](#) and CBIRH is working hard to get the rest online as funding and time allows.
- Framed work stored: **59 pieces**
- Intake (unprocessed): **102 donations** (all accessioned)

Object Collection:

On Exhibit:

- Main - **2,598 objects**
- Upper inside - **1,446 objects**; Upper outside - **145 objects** (includes 3 trucks, 1 caboose, 3 track maintenance vehicles, a crane, a tractor, and 7 underground mining locomotives)
- Geological Samples - **approx. 6,100 specimens** (more in storage)

In storage:

- Main - approx. **2750 objects**
- Upper Level - **450 objects**
- Intake - **0 objects**

On Loan:

- On Display: **263 objects** - majority of the Ski and Cominco wings, and Biking case
- Storage: **24 objects**

Permanent Collection Donations: 21 donors (82 artifacts)

Highlights

- David Anderson's skis from the 2002 Olympic Games - Philip Patterson
- Fraternal Order of Eagles memorabilia - Terry Brinson
- Red Mountain Ski Racers Hat - Patricia Stevens



Archival Donations: 24 donors (606 items - 61 digital)

Highlights:

- Deborah Rebekah Lodge #13 ledgers - Deborah Rebekah Lodge #13
- Ophir Reservoir Construction Photographs - Richie Mann

Education/Display Collection Donations: 9 donors (18 items)

Highlight: WWII-era army coat - Rossland Health Auxiliary Thrift Store

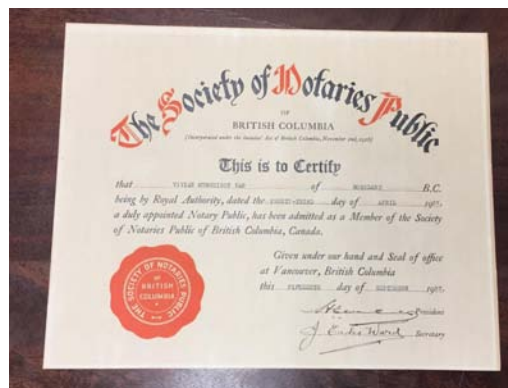

Funding and Earned Revenue

While visitor numbers aren't quite catching up to our pre-COVID years, we are very lucky that we are eligible for a number of relief and resiliency grants, including the Canada Emergency Wage Subsidies and operating support from the Department of Canadian Heritage, Columbia Basin Trust, the BC Arts Council, Vancouver Foundation, and more. We were able to secure **over \$380,000 in operating/wage grants** this year compared to over \$265,000 in 2020 and \$270,000 in 2019 - in part thanks to the core grants from the City of Rossland and BC Community Gaming Grants.

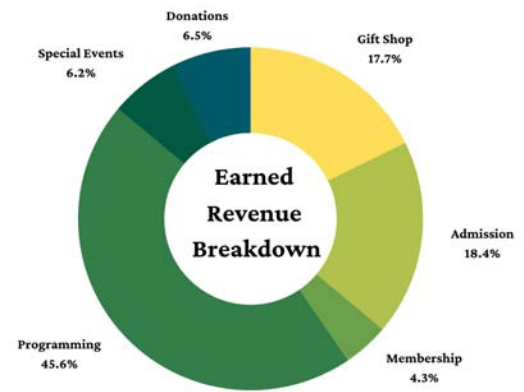
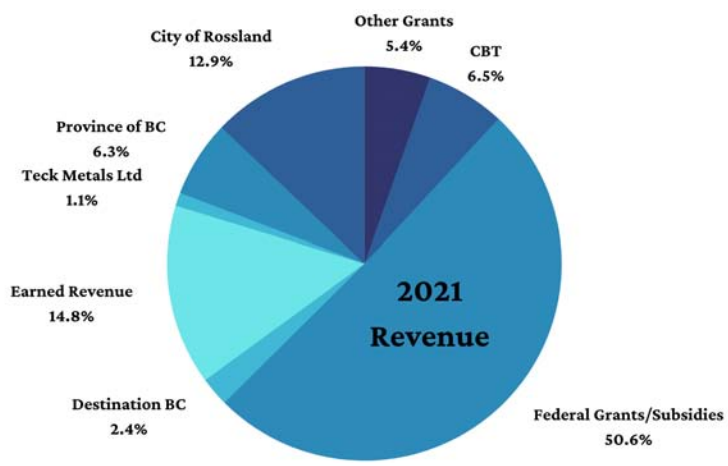
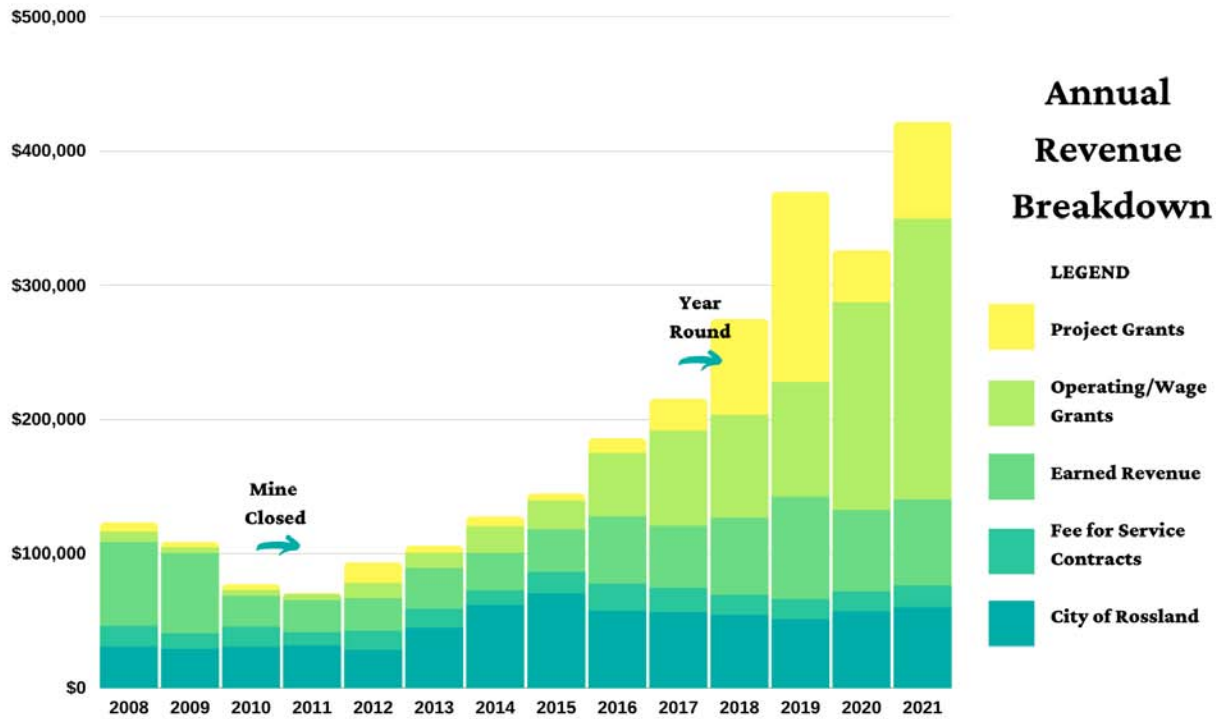

2022 Goals & Special Projects

In addition to our annual commitments, including educational programming, group/school tours, outreach displays and kits, community events, public research requests, speaker series, operating the visitor centre, and the upkeep/updates required for our permanent displays and archival and collections management, we always have a number of major projects to keep us busy, including:

- Develop a new 3-year Strategic Plan
- Continue the development of a comprehensive history of skiing on Red Mountain, including completing the Digital Museum of Canada virtual exhibition
- Expand gift shop offerings in line with our collection scope and mandate
- Complete content development for downtown, outdoor, and indoor virtual/audio tours
- Develop a Digital Collections Plan for the archives
- Expand our Indigenous content and engagement and develop a Memorandum of Understanding for our partnership with the Autonomous Sinixt
- Add to our Rossland Memories Oral History program and get new/backlogged interviews online
- Redevelop the upper level, including interactive/educational opportunities and ecological enhancement
- Expand our geology/ecology programs and content
- Expand Senior programming with community partners
- Develop teen/young adult programming with community partners
- Continue expanding our online offerings and resources to support a wider audience engagement
- Continue to upgrade the storage systems in our collections to ensure safe preservation

And, of course, complete the planning and fundraising for Phase Two: The Mine Experience:

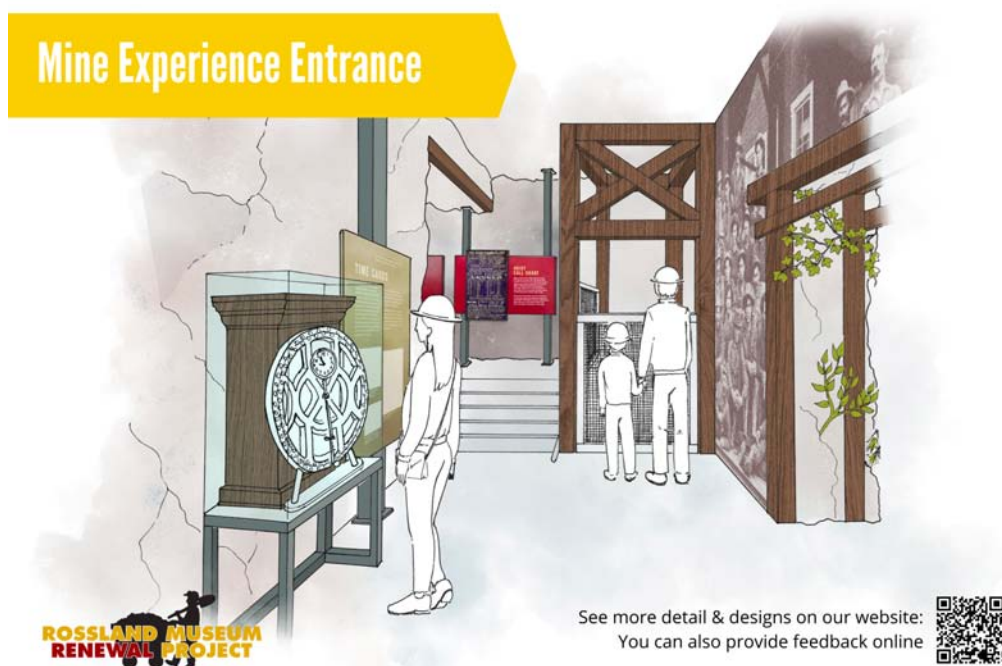

Renewal Project Update

This year, we dove right into the planning stages for Phase Two: The Mine Experience - thanks to planning grants from the Columbia Basin Trust and Canadian Heritage. Updates and many more preliminary designs can be found on our website: www.rosslandmuseum.ca/renewal



Interpretive Planning & Exhibition Design

We are so excited about our brand new Interpretive & Exhibition Plan developed by Double Dare Design.

Proposed Floor Plan

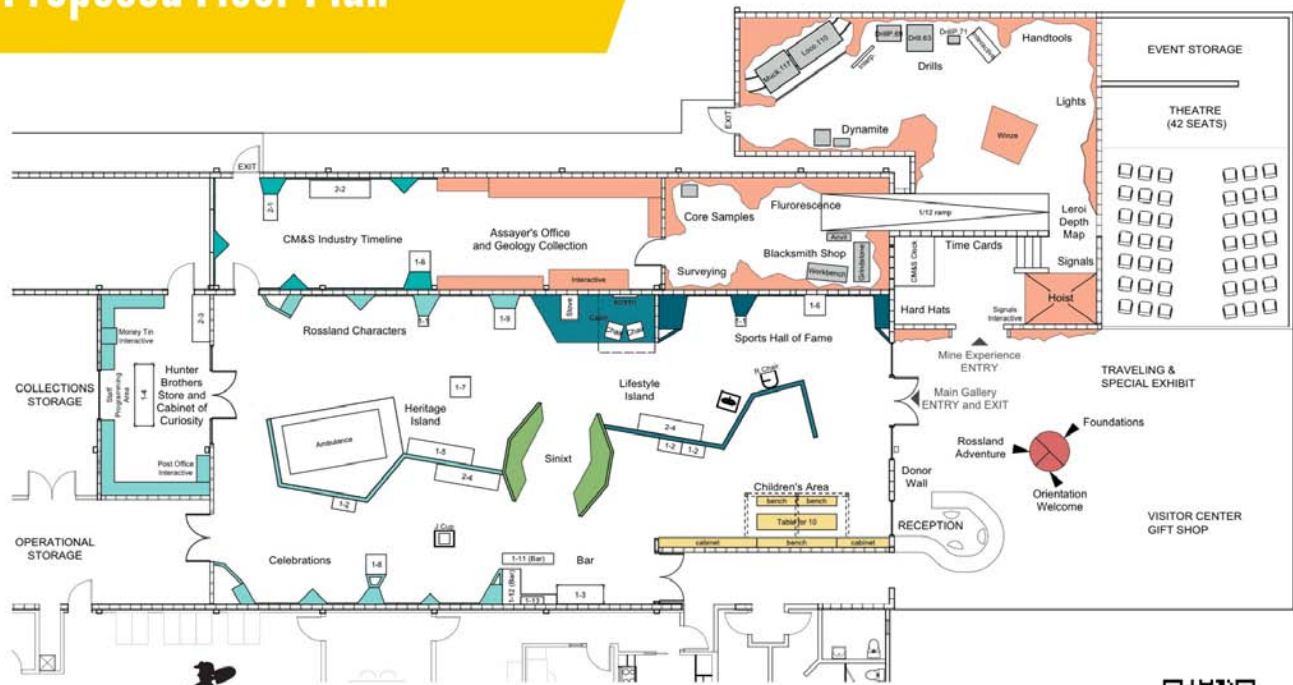

See more detail & designs on our website:
You can also provide feedback online



Mine Experience Interior



Lifestyle Exhibit Example



Architectural Consulting Services

Our Architects at Meiklejohn Architectural Design Studio Inc. have developed some incredibly eye-catching preliminary design work! The next steps on this project will be finalizing our cost estimates before going into the tender process to select our construction company! We couldn't be more excited to see this project come to life.

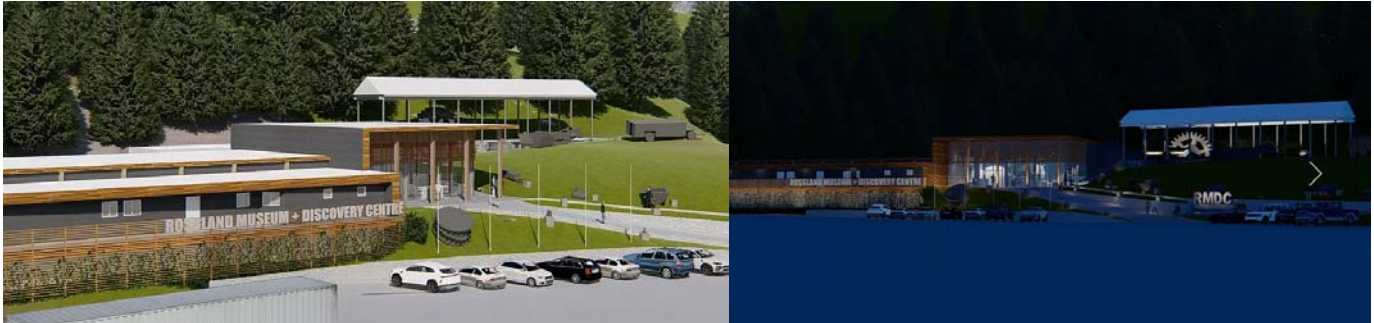

Fundraising

While we have been unable to host our annual Golf Tournament at Redstone Resort or host any other gatherings to support the Renewal project, we have developed a special fundraiser to help create a new mine tunnel map showing the depth and breadth of the Rossland Mines. We originally presented this idea as part of the Rotary Club of Rossland's "100 Rosslanders Who Care" fundraiser in early 2021, and while we were not successful in the grand prize, the high level of community support encouraged us to continue to [develop the project](#). As a result, we have received numerous private donations and a \$2500 donation from Rossland Rotary to help us get closer to our goal of making it all happen! Fundraising is still ongoing.



This mine tunnel map will be a transparent, 3D, topographic model of Rossland and area (Sophie, Red, Monte Christo, Columbia Kootenay Mtns. and the South Belt - lower Rossland), using projectors to display the network of mine tunnels throughout Rossland and the surrounding mountains. Using a control panel, visitors will be able to select which part of the model they would like to see highlighted - such as one of the Top 5 producing mines like the LeRoi or Josie, or the complete map of the mining tunnels in the area. The use of projectors allows for the option of adding new information to the map as it becomes available and to take advantage of the recent incredible innovations in projection technology. This is an exciting project that will serve as a unique and engaging introduction to the new Mine Tunnel Experience!

